

FLEX/ R&D SPACE AVAILABLE FOR LEASE



KEARNY MESA LANDING

4205 - 4247 PONDEROSA AVENUE | SAN DIEGO, CA 92123



Exclusively Represented By:

Voit
REAL ESTATE SERVICES

PROPERTY FEATURES



Easy Access to I-15,
Hwy 163 & Hwy 805



Central San Diego Location



Quiet Cul-de-sac Location



8 Buildings Flex Project
Totaling \pm 156,079 SF



Multiple Unit Sizes



Each Unit Designed With
Separate Entrances & Loading



12' - 14'
Clear Height



Grade Level
Loading Doors



3.17/1,000 SF
Parking Ratio



Outdoor Common Areas
With Seating



Quality Campus-like Project



Corporate Image



SITE PLAN



Building 4223 | Suite A

Total SF	2,962 SF
Office	55%
Rate	\$2.10 NNN (NNN=\$0.50/SF)
Status	Available October 1, 2023

FLOOR PLAN

Building 4223
Suite A

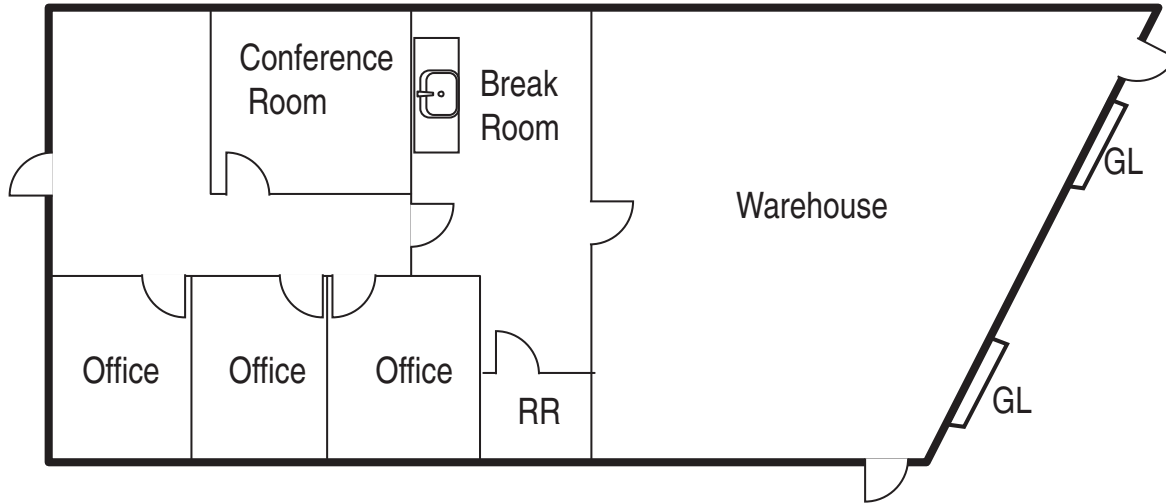

Total SF	2,962 SF
Office	55%
Warehouse	45%
Grade Level Doors	2
Lease Rate	\$2.10 NNN (NNN=\$0.50/SF)
Status	Available October 1, 2023



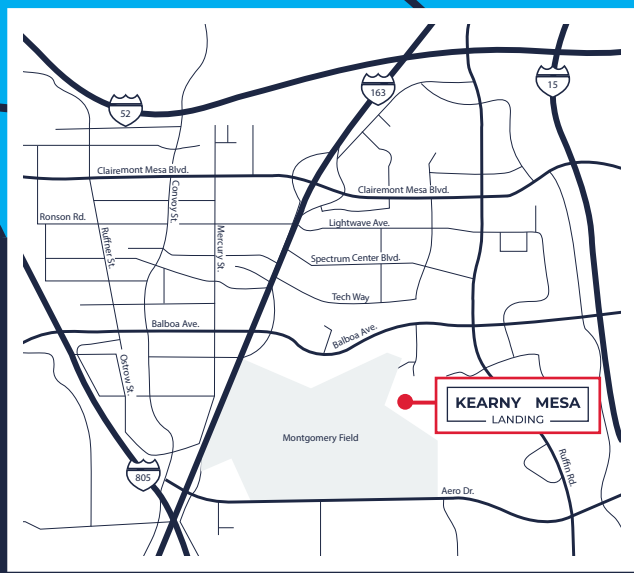

Contact Us

Randy LaChance
Executive Vice President

858.458.3374
rlachance@voitco.com
Lic.# 00969674

Chris Duncan, SIOR
Senior Vice President

858.458.3307
cduncan@voitco.com
Lic.# 01324067

Greg Marx
Vice President

858.458.3302
gmarx@voitco.com
Lic.# 01940696

4180 La Jolla Village Drive, Suite 100, La Jolla, CA 92037 | 858.453.0505 | Lic #01991785 | www.voitco.com

Licensed as Real Estate Salespersons by the DRE. The information contained herein has been obtained from sources we deem reliable. While we have no reason to doubt its accuracy, we do not guarantee it. ©2023 Voit Real Estate Services, Inc. All Rights Reserved.



Exclusively Represented By:

