

# FOR LEASE | WAREHOUSE / DISTRIBUTION SPACE

**8400 MIRAMAR ROAD, SUITE K  
SAN DIEGO, CA 92126**



## AVAILABILITY FEATURES:

- ±23,915 SF Warehouse/Distribution Space Available
- 5% Office
- Loading:
  - 3 Front Loading Dock Doors (Exclusive Area)
  - 2 Front Loading Shared Dock Doors
  - 1 Ramp
  - 5 Rear Dock Doors (Limited Loading Area)
- Miramar Road Signage
- Truck/Trailer Parking Area
- 27' - 30' Clear Height
- Fully Sprinklered
- Great Access I-805 and I-15
- Central San Diego Location
- Available November 1, 2022



**LEASE RATE: \$1.49 NNN**

**(NNN's=\$0.29/SF/Mo.)**

**RANDY LACHANCE, SIOR**  
Executive Vice President  
858.458.3374  
rlachance@voitco.com  
Lic. #00969674

**CHRIS DUNCAN, SIOR**  
Senior Vice President  
858.458.3307  
cduncan@voitco.com  
Lic. #01324067

**Voit**  
REAL ESTATE SERVICES

# FOR LEASE | WAREHOUSE / DISTRIBUTION SPACE

**8400 MIRAMAR ROAD, SUITE K**  
**SAN DIEGO, CA 92126**

## FLOOR PLAN

**8400 MIRAMAR RD., SUITE K**  
**23,915 SF**

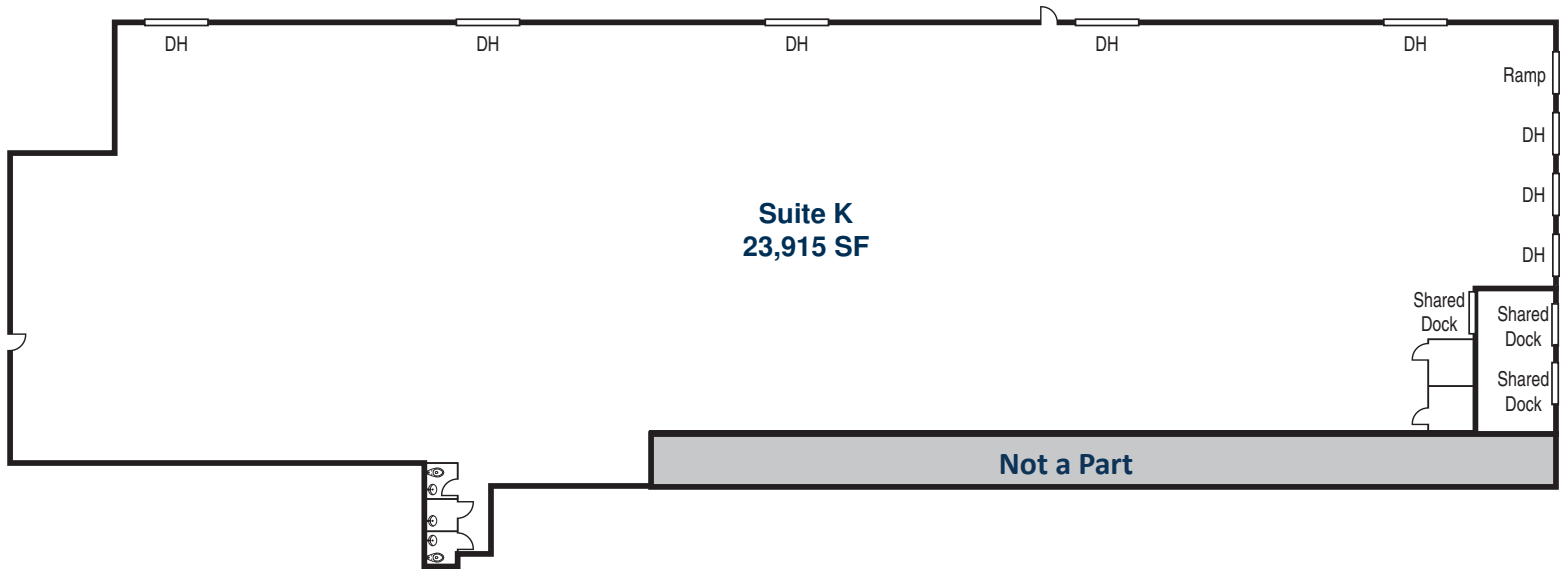

**SITE PLAN**

# FOR LEASE | WAREHOUSE / DISTRIBUTION SPACE

**8400 MIRAMAR ROAD, SUITE K**  
**SAN DIEGO, CA 92126**

## AERIAL MAP

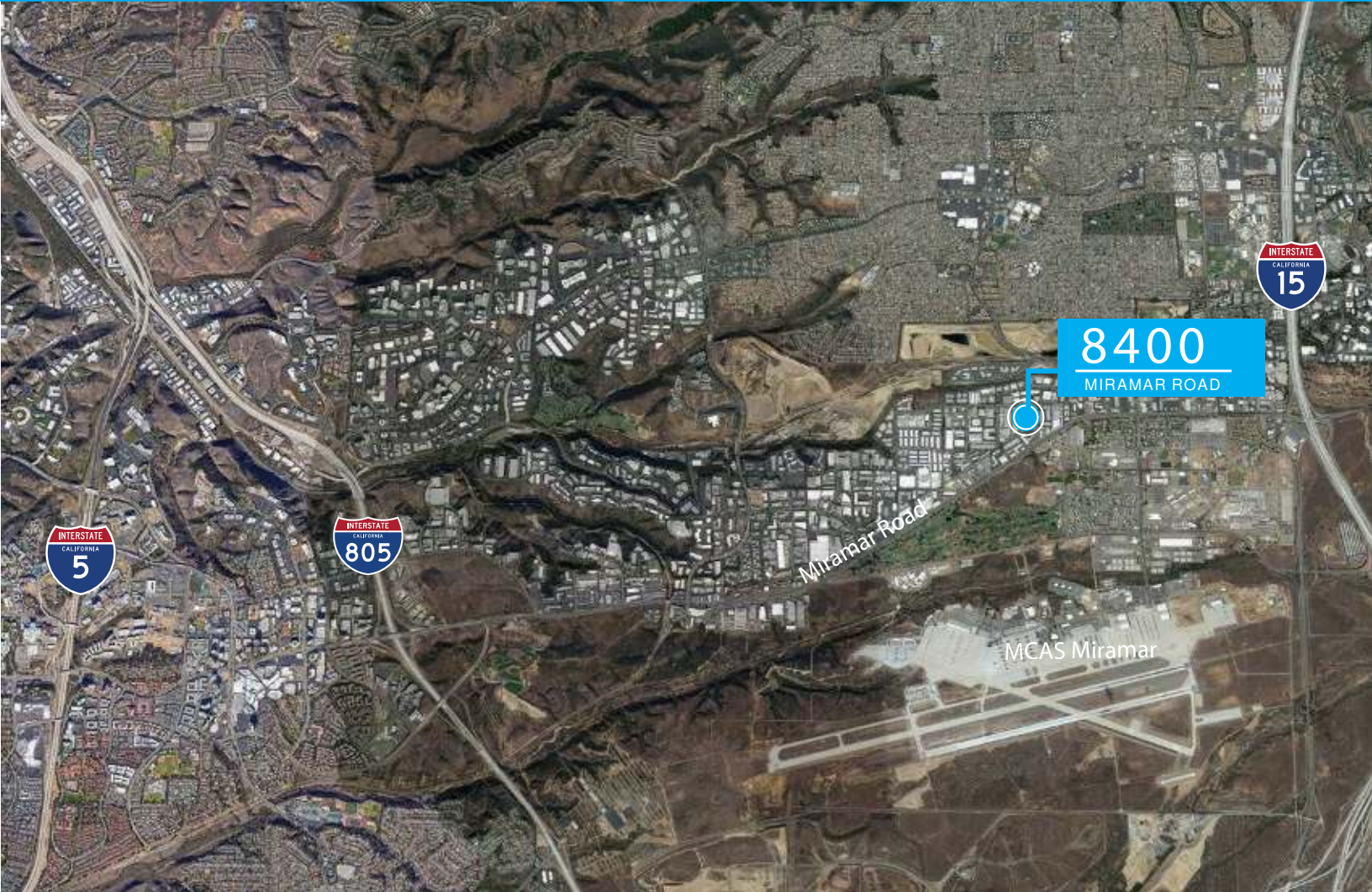

**RANDY LACHANCE, SIOR**  
Executive Vice President  
858.458.3374  
rlachance@voitco.com  
Lic. #00969674

**CHRIS DUNCAN, SIOR**  
Senior Vice President  
858.458.3307  
cduncan@voitco.com  
Lic. #01324067

**Voit**  
REAL ESTATE SERVICES

4180 La Jolla Village Drive, Suite 100, La Jolla, CA 92037 | 858.453.0505 | Lic #01991785 | [www.voitco.com](http://www.voitco.com)

Licensed as a Real Estate Salespersons by the DRE. The information contained herein has been obtained from sources we deem reliable. While we have no reason to doubt its accuracy, we do not guarantee it. ©2022 Voit Real Estate Services, Inc. All Rights Reserved.